

SEZ-AD09NL & SUZ-AA09NLHZ  
9,000 BTU/H LOW STATIC HORIZONTAL-DUCTED INDOOR UNIT  
9,000 BTU/H HYPER HEAT PUMP OUTDOOR UNIT



Job Name:

System Reference:

Date:



INDOOR Unit.....SEZ-AD09NL

OUTDOOR Unit.....SUZ-AA09NLHZ

#### INDOOR UNIT FEATURES

- Auto Changeover: The unit will automatically switch between heating and cooling modes to maintain your desired temperature.
- Light Commercial: Light commercial applications include small offices, restaurants, and retail.
- Multi Zone: A multi-zone unit provides personalized comfort control to multiple spaces.
- Three Speed Fan: Adjust the fan between three speed settings to optimal comfort.

#### OUTDOOR UNIT FEATURES

- Inverter Driven Compressor: Inverter technology uses only the precise amount of energy needed to keep a space comfortable.
- Seacoast Protection: Designed to protect against the corrosive effects of environments that are in close proximity to the sea.
- Hot Start: The system will warm up before blowing air, preventing blasts of cold air at start-up.
- H2i<sup>®</sup> Hyper-Heating: 100% heating performance down to 5° F with guaranteed heating down to -13° F.
- Freeze Base Pan Heater: This advanced base pan heater helps to prevent interrupted operation due to water freezing after a defrost cycle, ensuring your warmth and comfort during colder weather.
- Flash Injection: Flash Injection enables optimum compressor performance when it is running at higher speeds to maintain indoor comfort during cold temperatures.
- Blue Fin Coating: Anti-corrosion coating that protects the outdoor heat exchanger against salt, sulfur, and other airborne contaminants that impact the efficiency and performance of the outdoor units.

## SPECIFICATIONS: SEZ-AD09NL & SUZ-AA09NLHZ

Cooling at 95F <sup>1</sup>	Maximum Capacity	Btu/h	9,000
	Rated Capacity	Btu/h	9,000
	Minimum Capacity	Btu/h	4,800
	Maximum Power Input	W	760
	Rated Power Input	W	760
	Moisture Removal	Pints/h	2
	Sensible Heat Factor	-	0.75
Heating at 47F <sup>2</sup>	Power Factor [208V / 230V]	% / %	97 / 97
	Maximum Capacity	Btu/h	14,000
	Rated Capacity	Btu/h	12,000
	Minimum Capacity	Btu/h	10,500
	Maximum Power Input	W	1,530
	Rated Power Input	W	1,210
Heating at 17F <sup>3</sup>	Power Factor [208V / 230V]	% / %	98 / 98
	Maximum Capacity	Btu/h	12,000
	Rated Capacity	Btu/h	7,400
	Maximum Power Input	W	1,840
Heating at 5F <sup>5</sup>	Rated Power Input	W	1,050
	Maximum Capacity	Btu/h	12,000
Heating at -13F <sup>9</sup>	Maximum Power Input	W	1,850
	Maximum Capacity	Btu/h	7,300
Efficiency	SEER2		14.80
	EER2 <sup>1</sup>		11.80
	HSPF2 [IV]		8.10
	COP at 47°F <sup>2</sup>		2.90
	COP at 17°F at Maximum Capacity <sup>3</sup>		1.90
	COP at 5°F at Maximum Capacity <sup>5</sup>		1.90
	COP at -13°F at Maximum Capacity <sup>9</sup>		1.50
	ENERGY STAR <sup>®</sup> Certified		No
Electrical	Voltage, Phase, Frequency	V AC / V AC , ø , Hz	208 / 230 , 1 , 60
	Guaranteed Voltage Range	V AC - V AC	198 - 253
	Voltage: Indoor - Outdoor, S1-S2	V AC	208/230
	Voltage: Indoor - Outdoor, S2-S3	V DC	12-24
	Short-circuit Current Rating [SCCR]	kA	5
	Recommended Fuse/Breaker Size (Outdoor)	A	25
	Recommended Wire Size [Indoor - Outdoor]	AWG	14
Indoor Unit	MCA	A	0.95
	Fan Motor Output	W	96
	Fan Motor Type		DC Motor
	Airflow Rate at Cooling, Dry	CFM	194 , 247 , 317
	Airflow Rate at Heating, Dry	CFM	194 , 247 , 317
	Sound Pressure Level [Cooling]	dB (A)	23 , 26 , 30
	Sound Pressure Level [Heating]	dB (A)	23 , 26 , 30
	External Static Pressure	in.WG	0.02 , 0.06 , 0.14 , 0.20
	Drain Pipe Size O.D.	inch [ mm ]	1-1/4 [ 32 ]
	Dual Barrier Coating on Heat Exchanger		No
	Unit Dimensions (W x D x H)	inch x inch x inch [ mm x mm x mm ]	31-1/8 x 27-9/16 x 7-7/8 [ 790 x 700 x 200 ]
	Package Dimensions (W x D x H)	inch x inch x inch [ mm x mm x mm ]	39-3/8 x 35-7/16 x 14-3/16 [ 1,000 x 900 x 360 ]
	Unit Weight	lbs [ kg ]	42 [ 19 ]
	Package Weight	lbs [ kg ]	62 [ 28 ]
IDU Operating Temp. Range	Cooling Intake Air Temp [Maximum / Minimum]	°FDB , °FWB / °FDB , °FWB	90 , 73 / 66 , 59
	Heating Intake Air Temp [Maximum / Minimum]	°FDB / °FDB	83 / 50

### NOTES

<sup>1</sup>Cooling at 95°F (Indoor: 80°F DB, 67°F WB // Outdoor: 95°F DB, 75°F WB)

<sup>2</sup>Heating at 47°F (Indoor: 70°F DB, 60°F WB // Outdoor: 47°F DB, 43°F WB)

<sup>3</sup>Heating at 17°F (Indoor: 70°F DB, 60°F WB // Outdoor: 17°F DB, 15°F WB)

<sup>5</sup>Heating at 5°F (Indoor: 70°F DB, 60°F WB // Outdoor: 5°F DB, 4°F WB)

<sup>9</sup>Heating at -13°F (Indoor: 70°F DB, 60°F WB // Outdoor: -13°F DB, -14°F WB)

<sup>\*</sup> Indoor/Outdoor Unit Operating Temperature Range (Cooling Air Temp [Maximum / Minimum]):

• Applications should be restricted to comfort cooling only; equipment cooling applications are not recommended for low ambient temperature conditions.

\*\* Outdoor Unit Operating Temperature Range (Cooling Thermal Lock-out / Re-start Temperatures; Heating Thermal Lock-out / Re-start Temperatures):

• System cuts out in heating mode and automatically restarts at these temperatures.

## SPECIFICATIONS: SEZ-AD09NL & SUZ-AA09NLHZ

Outdoor Unit	MCA	A	24
	MOCP	A	41
	Fan Motor Output	W	50
	Airflow Rate Cooling	CFM	2,193
	Airflow Rate Heating	CFM	1,949
	Defrost Method		Reverse Cycle
	Coating on Heat Exchanger (Bluefin, Sea Coast)		Yes
	Sound Pressure Level, Cooling <sup>1</sup>	dB (A)	54
	Sound Pressure Level, Heating <sup>2</sup>	dB (A)	55
	Compressor Type		Twin Rotary
	Compressor Model		SRB172FQHMT
	Compressor Oil [Type // Charge]	Type // oz	RM68EH // 14.5
	External Finish Color		Munsell No.3Y 7.8/1.1
	Base Pan Heater		Built-in
	Unit Dimensions (W x D x H)	inch x inch x inch [ mm x mm x mm ]	33-1/16 x 13 x 34-5/8 [ 840 x 330 x 880 ]
	Package Dimensions (W x D x H)	inch x inch x inch [ mm x mm x mm ]	38-5/8 x 16-9/16 x 39 [ 980 x 420 x 990 ]
	Unit Weight	lbs [ kg ]	115 [ 52.16 ]
	Package Weight	lbs [ kg ]	133 [ 60.33 ]
ODU Operating Temp. Range	Cooling Intake Air Temp [Maximum / Minimum*]	°FDB / °FDB	115 / 14
	Cooling Thermal Lock-out / Re-start Temperatures**	°FDB / °FDB	-1 / 3
	Heating Intake Air Temp [Maximum / Minimum]	°FDB , °FWB / °FDB , °FWB	75 , 65 / -13 , -14
	Heating Thermal Lock-out / Re-start Temperatures**	°FDB / °FDB	-22.5 / -14
Refrigerant	Type		R454B
	Pre-Charged Refrigerant Amount	lbs	3
	Maximum Pre-Charged Piping Length	ft [ m ]	25 [ 7.6 ]
	Additional Refrigerant Charge Per Additional Piping Length	oz/ft	0.22
Piping	Gas Pipe Size O.D. [Flared]	inch [ mm ]	3/8 [ 9.52 ]
	Liquid Pipe Size O.D. [Flared]	inch [ mm ]	1/4 [ 6.35 ]
	Maximum Piping Length	ft [ m ]	100 [ 30 ]
	Maximum Height Difference	ft [ m ]	50 [ 15 ]
<b>NOTES</b> <sup>1</sup> Cooling at 95°F (Indoor: 80°F DB, 67°F WB // Outdoor: 95°F DB, 75°F WB) <sup>2</sup> Heating at 47°F (Indoor: 70°F DB, 60°F WB // Outdoor: 47°F DB, 43°F WB) <sup>3</sup> Heating at 17°F (Indoor: 70°F DB, 60°F WB // Outdoor: 17°F DB, 15°F WB) <sup>4</sup> Heating at 5°F (Indoor: 70°F DB, 60°F WB // Outdoor: 5°F DB, 4°F WB) <sup>5</sup> Heating at -13°F (Indoor: 70°F DB, 60°F WB // Outdoor: -13°F DB, -14°F WB) * Indoor/Outdoor Unit Operating Temperature Range (Cooling Air Temp [Maximum / Minimum]): • Applications should be restricted to comfort cooling only; equipment cooling applications are not recommended for low ambient temperature conditions. ** Outdoor Unit Operating Temperature Range (Cooling Thermal Lock-out / Re-start Temperatures; Heating Thermal Lock-out / Re-start Temperatures): • System cuts out in heating mode and automatically restarts at these temperatures.			

## INDOOR UNIT ACCESSORIES: SEZ-AD09NL

Condensate	Blue Diamond (MegaBlue Advanced) Condensate Pump w/ Reservoir & Sensor	X87-835
	Refco Condensate Pump 100-240V up to 120k BTU/h	COMBI
	Saueremann Condensate Pump	SI30-230
	Blue Diamond MicroBlue Condensate Pump 115-230V up to 18k BTU/h	X86-003
	Blue Diamond (Advanced) Mini Condensate Pump w/ Reservoir & Sensor (208/230V) [recommended]	X87-721
	Blue Diamond (MaxiBlue Advanced) Mini Condensate Pump w/ Reservoir & Sensor (110V) up to 48,000 BTU/H [recommended]	X87-711
	Blue Diamond Sensor Extension Cable — 15 Ft.	C13-103
	Blue Diamond MultiTank — collection tank for use with multiple pumps	C21-014
Control Interface	Airzone Wireless Lite Controller White	AZZBSLITERB
	Airzone Wireless Think Controller White	AZZBSTHINKRB
	Airzone Wired Blueface Controller Black	AZZBSBLUEZEROCN
	Airzone Wireless Think Controller Black	AZZBSTHINKRN
	Airzone Wired Lite Controller Black	AZZBSLITECN
	Airzone Wired Blueface Controller White	AZZBSBLUEZEROCB
	Wireless Interface 2 for Comfrot app	PAC-USWHS002-WF-2
	Airzone Wired Lite Controller White	AZZBSLITECB
	Operation and Error Status Output Adapter	PAC-SF40RM-E
	kumo station® for Comfort app	PAC-WHS01HC-E
	IT Extender	PAC-WHS01IE-E
	Thermostat Interface for 3rd Party Thermostats	PAC-US445CN-1
Control Wire	Airzone Wireless Lite Controller Black	AZZBSLITERN
	202PR shielded 1PR plenum wire for Airzone 500 ft reel	CW2042S2-500
Disconnect Switch	202PR 1PR shielded 1PR plenum wire for Airzone 100 ft reel	CW2042S2-100
	30A600VUL fits 2 X 4 utility box - Black	TAZ-MS303
Filter Box	(30A/600V/UL) [fits 2" X 4" utility box] - White	TAZ-MS303W
	Filter Box with MERV 8 Filter	FBL1-1
Lineset	15 x 1/4 x 15 3/8 Lineset Twin-Tube Insulation	MLS143812T-15
	50 x 1/4 x 50 3/8 Lineset Twin-Tube Insulation	MLS143812T-50
	30 x 1/4 x 30 3/8 Lineset Twin-Tube Insulation	MLS143812T-30
	65 x 1/4 x 65 3/8 Lineset Twin-Tube Insulation	MLS143812T-65
Remote Sensor	Wall Mounted Remote Temperature Sensor	PAC-SE41TS-E
	Wireless temperature and humidity sensor for Comfort app	PAC-USWHS003-TH-1
	Flush Mount Remote Temperature Sensor for SEZ SLZ SVZ and all P-Series models	PAC-USSEN002-FM-1
Terminal Signal Adapter	Connector and wire for Operation status/error using CN51	PAC-725AD
	CN24 Relay Kit	CN24RELAY-KIT-CM3
	3-Pin Connector	PAC-715AD
Wired Remote Controller	Touch MA Controller†	PAR-CT01MAU-SB
	Simple MA Remote Controller	PAC-YT53CRAU-J
	Simple Direct Wired Remote Controller	PAC-SDW01RC-1
	Deluxe MA Wired Remote Controller	PAR-42MAAUB
Wireless Remote Controller	Wireless RedLINK™ Remote Controller	MHK2
	Universal Wireless Receiver for PAR-FL32MA-E	PAR-FA32MA-W
	Wireless Universal Signal Receiver (for PAR-SL101A-E)	PAR-SA9CA-E
	Lockdown Bracket for Wireless Handheld Remote Controllers	RCMKP1CB
NOTES		

## OUTDOOR UNIT ACCESSORIES: SUZ-AA09NLHZ

Air Outlet Guide	Air Outlet Guide	MAC-890SG-E
Control/Service Tool	Maintenance Tool Interface	PAC-USCMS-MN-1
	M- & P-Series Maintenance Tool Cable Set	M21EC0397
Drain Socket	Drain Socket	MAC-871DS
Hail Guards	Hail Guard	HG-A7
Mini-Split Wire	14 Gauge 4 wire MiniSplit Cable250 ft roll	S144-250
	14 Gauge 4 wire MiniSplit Cable50 ft roll	S144-50
	14 Gauge 4 wire Armored MiniSplit Cable250 ft roll	SW144-250
	14 Gauge 4 wire Armored MiniSplit Cable50 ft roll	SW144-50
Mounting Pad	Condensing Unit Mounting Pad 16 x 36 x 3	ULTRILITE1
Muffler	Muffler	MAC-001MF-E
Snow/Rain Diverter	SnowRain Diverter	SRD-3
Stand	Condenser Wall Bracket	QSWB2000M-1
	Condenser Wall Bracket - Stainless Steel Finish	QSWBSS
	Outdoor Unit 3-14 inch Mounting Base Pair - Plastic	DSD-400P
	18 Single Fan Stand	QSMS1801M
	Outdoor Unit Stand 12 High	QSMS1201M
	24 Single Fan Stand	QSMS2401M
NOTES		

# INDOOR UNIT DIMENSIONS: SEZ-AD09NL

Model	A	B	C	D	E	F	G	H	J	K	L	M	① Gas pipe	② Liquid pipe
SEZ-AD09NL	700 (27-9/16)	752 (29-5/8)	798 (31-7/16)	660 (26)	600 (23-5/8)	660 (26)	500 (19-11/16)	16	839 (33-11/16)	16	839 (33-11/16)	790 (31-11/8)	φ9.52 (3/8)	φ6.35 (1/4)
SEZ-AD12NL	900 (35-7/16)	952 (37-1/2)	998 (39-5/16)	860 (33-7/8)	800 (31-1/2)	860 (33-7/8)	700 (27-9/16)	7	1039 (40-29/32)	20	1039 (40-29/32)	990 (39)	φ12.7 (1/2)	φ6.35 (1/4)
SEZ-AD15NL	1100 (43-5/16)	1152 (45-3/8)	1198 (47-3/16)	1060 (41-5/4)	1000 (39-3/8)	1060 (41-3/4)	900 (35-7/16)	9	1239 (48-25/32)	24	1239 (48-25/32)	1190 (46-7/8)	φ12.7 (1/2)	φ6.35 (1/4)

Unit:mm(in.)

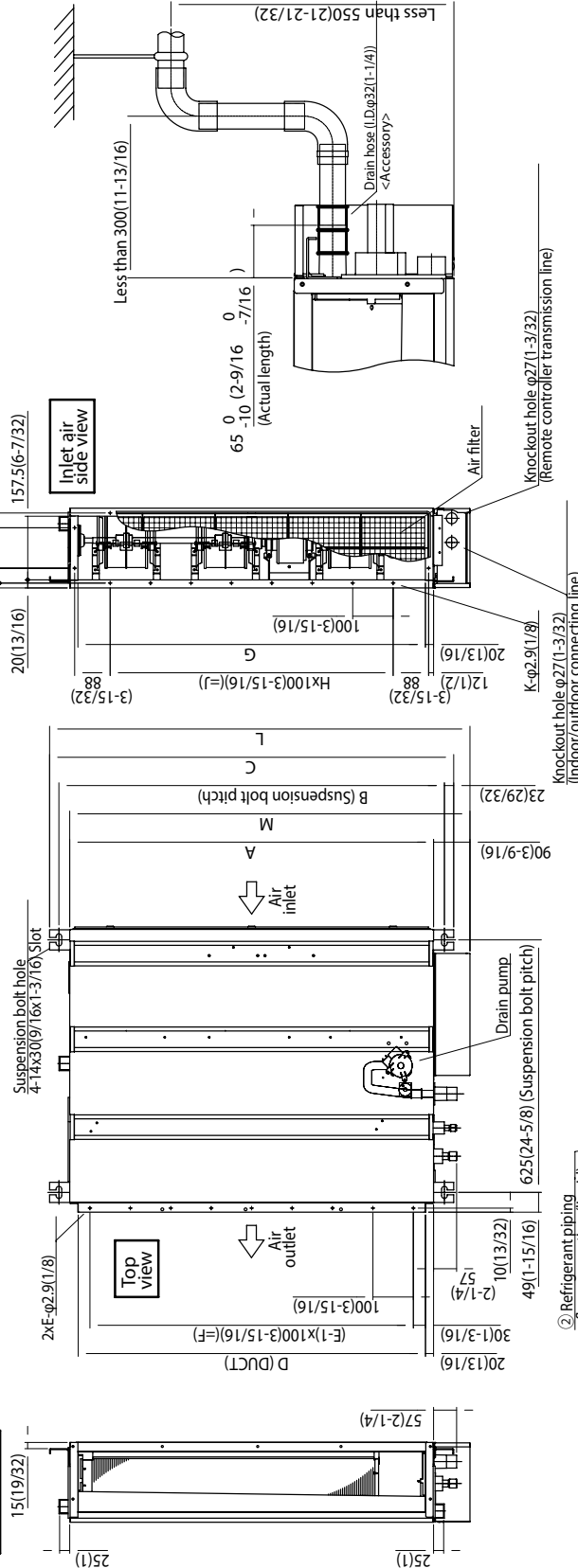
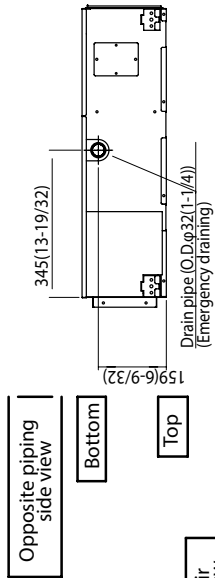

- Note 1. Use M10 screw for the suspension bolt (field supply).
- 2. Keep the service space for the maintenance at the bottom.
- 3. This chart indicates for SEZ-AD15NL model, which have 3 fans. SEZ-AD09・12NL models have 2 fans. SEZ-AD18NL model have 4 fans.
- 4. In case of the inlet duct is used, remove the air filter (supply with the unit), then install the filter (field supply) at suction side.

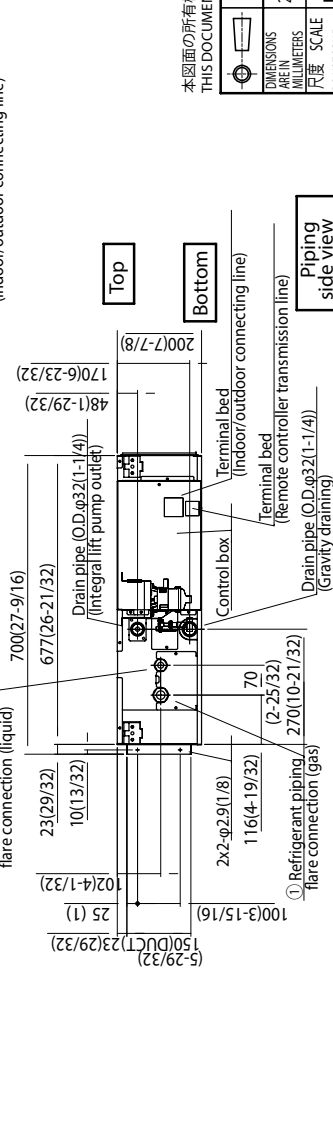

本図面の所有権は三菱電機株式会社にある。  
THIS DOCUMENT IS THE PROPERTY OF MITSUBISHI ELECTRIC CORPORATION.

作成日付 改定日付  
ISSUED REVISED  
2024-06-13

EXTERNAL DIMENSION  
SEZ-AD09-12-15-18NL

尺碼 SCALE  
DO NOT SCALE

DWG. NO. **MITSUBISHI ELECTRIC C-RP-RATI-N** W K894C7QH  
REV. 1/2

# OUTDOOR UNIT DIMENSIONS: SUZ-AA09NLHZ

## REQUIRED SPACE

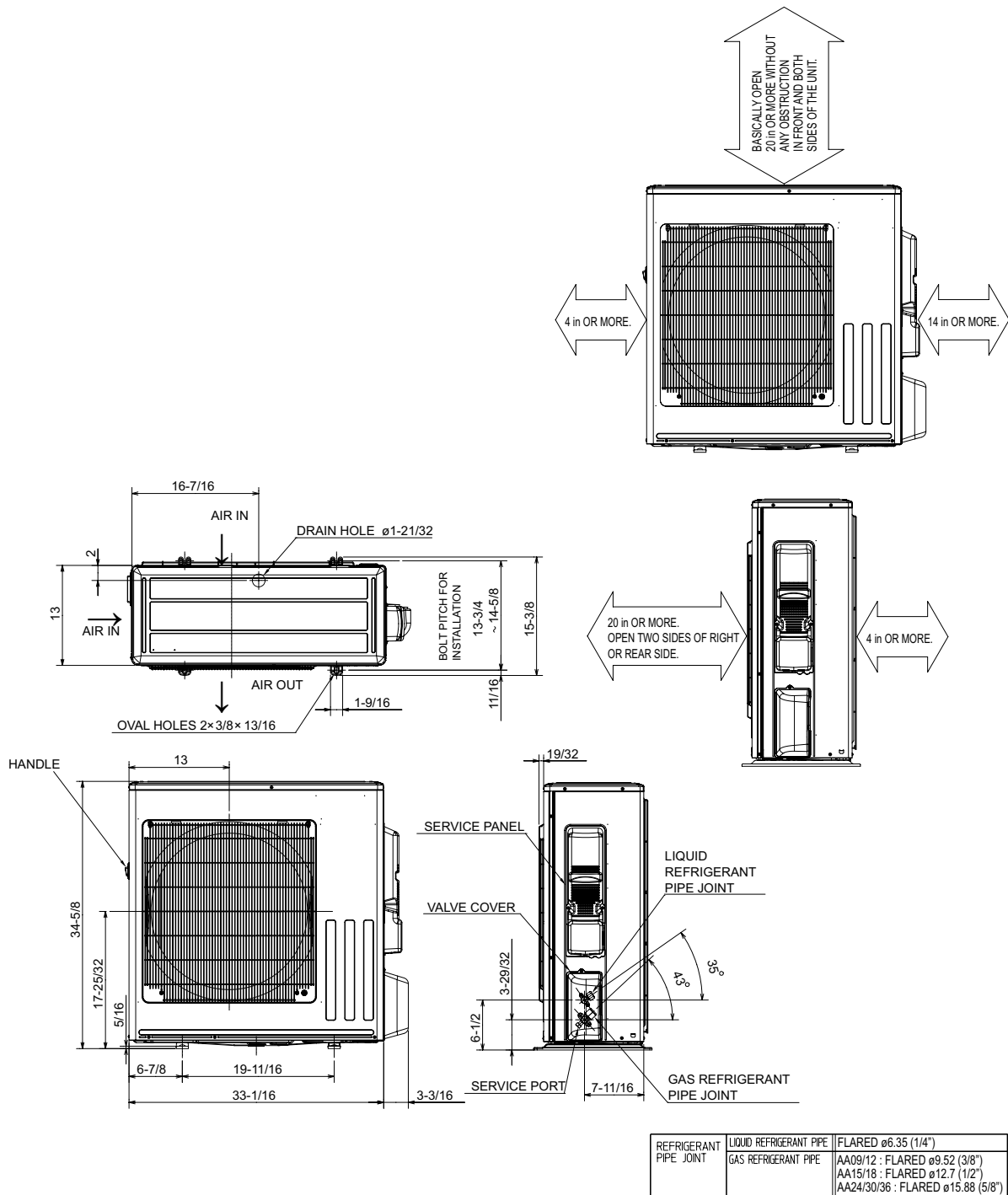

METUS\_2026-01\_PROPIN

1340 Satellite Boulevard Suwanee, GA 30024  
Toll Free: 800-433-4822 <https://mitsubishicomfort.com>

